

CRYSTAL DISPLAY SYSTEMS

RUGGED TOUCH

TOUCH FOR HARSH ENVIRONMENTS



IDEAL FOR INDUSTRIAL, VENDING & OUTDOOR

SIZES

From 7" up to 32"

BENEFITS

- High-performance touch experience
- Reliable for outdoor environments
- Easy and versatile integration
- Compatibility with wire

KEY FEATURES:

- Custom designed sensor
- Works with glass thickness up to 20 mm
- Flexible projected capacitive sensor
- Glove-compatible touch

TYPICAL INSTALATIONS:

- Industrial
- Kiosks and Ticketing Machines
- Outdoor Touch Applications
- Vending and ATM
- Transportation and Interactive Signage

SPECIFICATIONS

20

Up to 20mm
Glass Thickness



Resistant to Rain,
Dust, Ice and UV

32
7

Up to 32"

9 ms

Fast Response

5

5 Finger Touches



TECHNICAL SPECIFICATIONS

GENERAL

Detection Method	Projected Capacitive Technology
Input Method	Multitouch Finger and Gloved Finger
Number of Simultaneous	5
Touches Film Sensor Thickness	100 Micron transparent polymer film
Noise Shielding	Proprietary noise filtering technology
Sizes	7" to 32"
Aspect Ratio	Custom designed sensor
Controller	Printed circuit board with mini USB connector
Adhesive	Permanent or Removable
Substrate	Glass and other non-conductive materials
Interface Data	USB HID (standard); SPI, I2C, SERIAL TTL/RS232 (on request)
Connectivity	USB 2.0 with Mini-USB Connector (standard); Industrial USB Connector (request)
Touch Accuracy	<1mm in 15" with 4mm glass
Controller Weight	10 g
USB Cable Length	Up to 2m (not included)
Trackpad Emulator	Available
OS with Multitouch	Windows 7 and later, Ubuntu, Android and other Multitouch Enabled OS
OS with Single Touch	Mac OS (Multitouch Support Through TUIO Bridge for Applications)
OS with Mouse Emulation	Detected automatically on supported OS

PERFORMANCE

Substrate Thickness	Up to 20 mm
Touch Response	9 milliseconds
Calibration	Confirmed

POWER CONSUMPTION

Ave Power Consumption	USB powered @ 5 V DC Operation consumption: 120 mA
-----------------------	---

RELIABILITY

Operating Temperature	-20°C to 70°C
Range Storage Temperature	-30°C to 80°C
Range Operating Humidity Range	0% to 95%, at 60°C, non-condensing
Storage Humidity Range	0% to 100%, non-condensing
Touch Sensor Life Time	Unlimited
Expectancy Touch Controller Life	1 million hours
Time Expectancy Warranty	2 years

TECHNICAL DRAWINGS

Front View

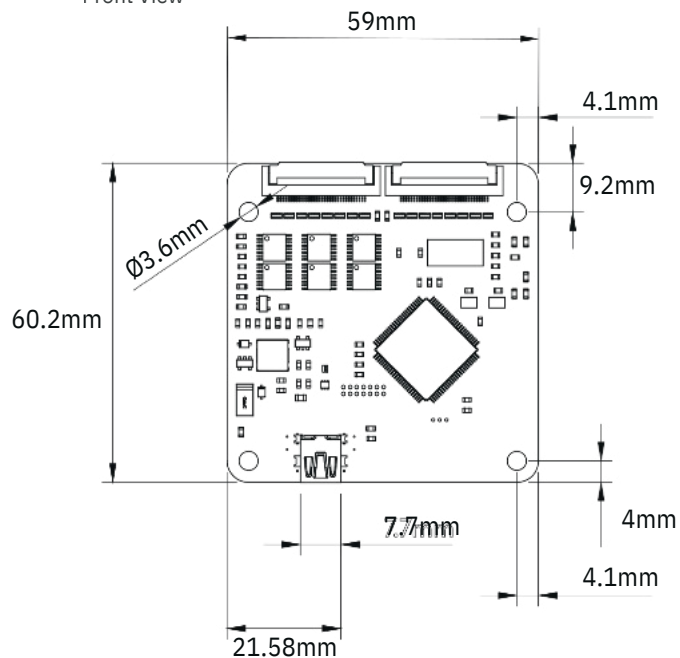

Back View

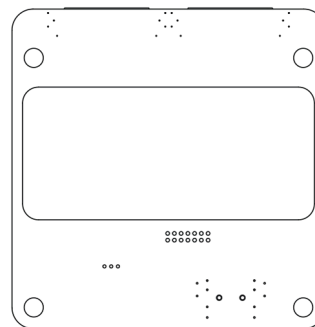

TECHNICAL DRAWINGS

Front View

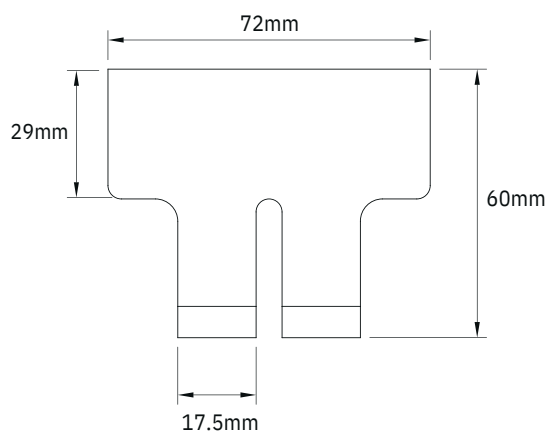

Back View

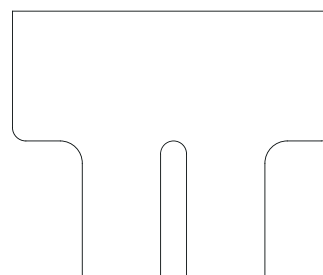

Need any additional information?

If you need any assistance with pricing information, technical support or require any additional information our team would be more than happy to assist



CONTACT US:

Crystal Display Systems Ltd
Unit 6 M2M Park, Fort Bridgewood
Maidstone Road, Rochester,
Kent. ME1 3DQ

T : +44(0) 1634 791600

E : info@crystal-display.com

W : crystal-display.com

SPECIALIST GLOBAL SUPPLIERS IN INNOVATIVE LCD
DISPLAY, TOUCH AND DIGITAL SIGNAGE SOLUTIONS